

W:\Departmental\Planning Design & Development\BKP Data\Projects\AUTOCAD\Parks Under Design\Phase XVI\Plaza Northgate Park.dwg -- Tuesday April 16, 2019, 8:4

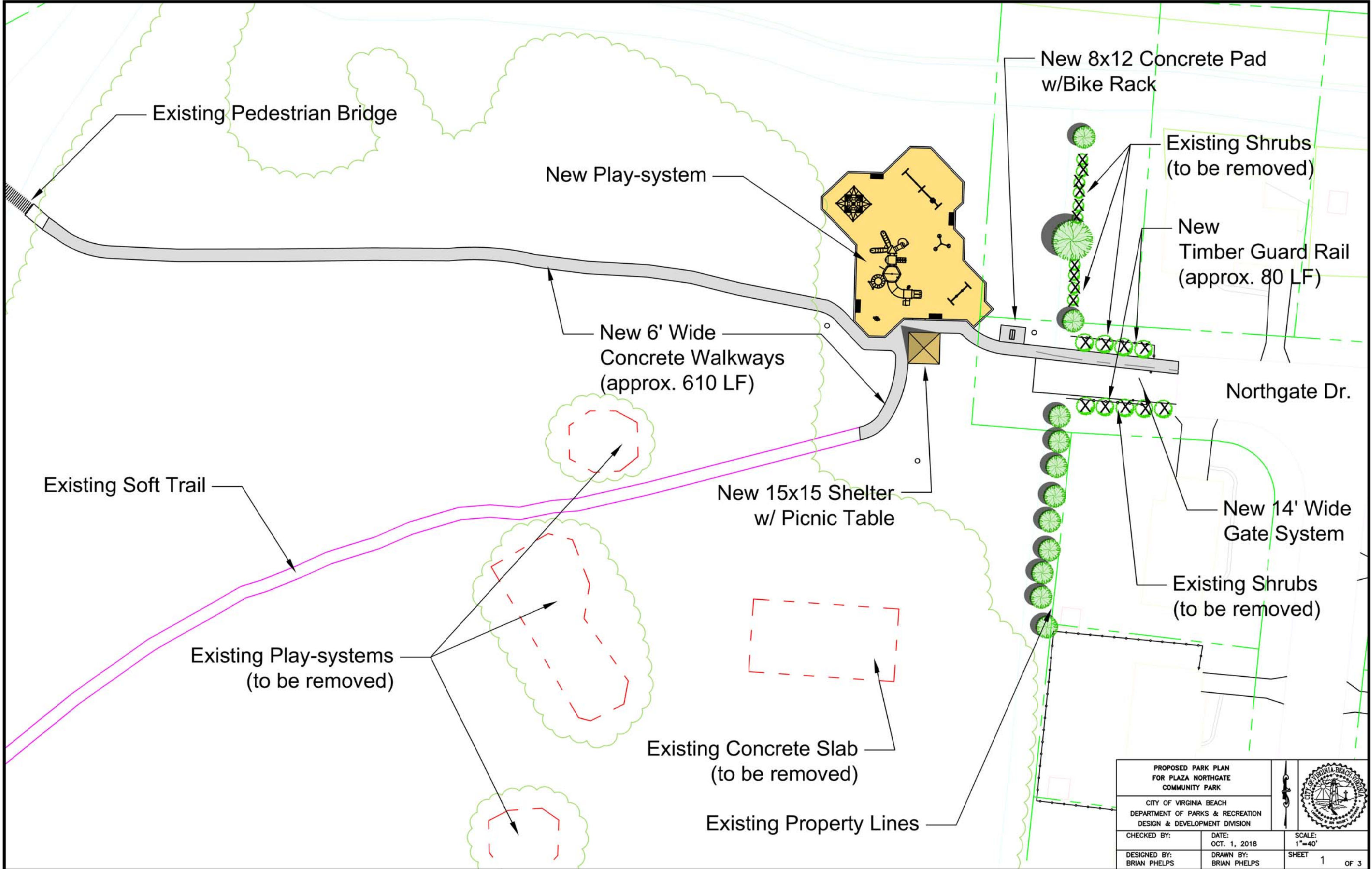

Existing Pedestrian Bridge

New Play-system

New 8x12 Concrete Pad w/Bike Rack

Existing Shrubs (to be removed)

New Timber Guard Rail (approx. 80 LF)

New 6' Wide Concrete Walkways (approx. 610 LF)

Northgate Dr.

Existing Soft Trail

New 15x15 Shelter w/ Picnic Table

New 14' Wide Gate System

Existing Play-systems (to be removed)

Existing Shrubs (to be removed)

Existing Concrete Slab (to be removed)

Existing Property Lines

PROPOSED PARK PLAN FOR PLAZA NORTHGATE COMMUNITY PARK			
CITY OF VIRGINIA BEACH DEPARTMENT OF PARKS & RECREATION DESIGN & DEVELOPMENT DIVISION			
CHECKED BY:	DATE:	SCALE:	SHEET 1 OF 3
DESIGNED BY:	DRAWN BY:		
BRIAN PHELPS	BRIAN PHELPS	1"=40' OCT. 1, 2018	